

## RADAR URINAL FLUSHING UNITS



# RADAR FLUSHING UNITS BENEFITS

**We have been manufacturing Radar urinal flushers in our factory for more than 20 years.** It is an innovative technology that offers high precision and functionality. Sanela's radar technology senses the movement of liquids inside the urinal and, based on the evaluation of the movement data, flushes whenever it has. Unlike many competing products, the Sanela Radar Flusher is not in contact with water, all detection is through the ceramic and therefore this system excels in durability. This product is also very environmentally friendly and economical as it allows flushing with small amounts of water, where this parameter is easily adjustable. Since 2023, we have implemented Bluetooth technology in our Radar flushers, which makes it possible to set many different parameters using only a mobile phone (Sanela Control app).



## SETTING PARAMETERS BY BLUETOOTH

WITHOUT DISASSEMBLING THE DEVICE (PAID SANELA CONTROL APP AVAILABLE FOR DOWNLOAD ON THE APP STORE AND GOOGLE PLAY)



## AUTOMATIC FLUSHING AFTER EACH USE OF THE URINAL

SYSTEM ANALYSES CHANGES, WHICH ARE PROCEEDED INSIDE OF THE URINAL



## ECONOMY FLUSHING BY 1 LITER OF WATER

CAN BE EVEN LOWER IF THE SIPHON OR URINAL ALLOWS IT (ADJUSTABLE PARAMETER)



## VANDAL-PROOF

HIGHLY RESISTANT TO WEAR AND MECHANICAL DAMAGE



## CLEAN DESIGN

MOST OF THE ARCHITECTS CHOOSE HIDDEN FLUSHING



## EXTENDED 5 YEARS GUARANTEE

ON THE PROPER FUNCTION OF THE ELECTRONICS



## ADJUSTMENT OF PARAMETERS BY REMOTE CONTROL

PARAMETERS ARE POSSIBLE TO ADJUST WITHOUT DISASSEMBLY OF THE URINAL



## HYGIENIC FLUSH

AUTOMATIC FLUSHING AFTER EACH 6 HOURS NON-USE (ADJUSTABLE PARAMETER)



## WATER OVERFLOW PROTECTION



## EASY INSTALLATION



## LONG LIFE

UP TO THREE LIFE OF THE STANDARD PRODUCTS



## MADE IN EUROPE



## PLUG & PLAY

EASY INSTALLATION, JUST CONNECT WATER AND ELECTRICITY

# URINALS WITH RADAR FLUSHING UNIT **PLUG & PLAY**

## URINAL FELIX WITH THE RADAR FLUSHING UNIT, (PLUG & PLAY)



SLP 07RS	11075	24 V DC
SLP 07RZ	01075	230 V AC
SLP 07RB	11077	6 V

## URINAL GOLEM WITH THE RADAR FLUSHING UNIT, (PLUG & PLAY)



SLP 19S	01196	24 V DC
SLP 19Z	01197	230 V AC
SLP 19B	21195	6 V

## URINAL ALEX WITH THE RADAR FLUSHING UNIT, (PLUG & PLAY)



SLP 18RS	11185	24 V DC
SLP 18RZ	01185	230 V AC
SLP 18RB	11187	6 V

## URINAL CAPRINO WITH THE RADAR FLUSHING UNIT, (PLUG & PLAY)



SLP 23S	01233	24 V DC
SLP 23Z	01234	230 V AC
SLP 23B	01232	6 V

## URINAL CAPRINO PLUS RIMLESS WITH THE RADAR FLUSHING UNIT, (PLUG & PLAY)



SLP 49S	01498	24 V DC
SLP 49Z	01499	230 V AC
SLP 49B	01492	6 V

## URINAL WCA WITH THE RADAR FLUSHING UNIT, (PLUG & PLAY)



SLP 82RS	01820	24 V DC
SLP 82RZ	01822	230 V AC
SLP 82RB	01821	6 V

# URINALS WITH RADAR FLUSHING UNITS

## URINAL LEMA RIMLESS WITH THE RADAR FLUSHING UNIT



SLP 59RS	11596	24 V DC
SLP 59RZ	01595	230 V AC
SLP 59RB	11597	6 V

## BLACK URINAL LA FONTANA WITH THE RADAR FLUSHING UNIT



SLP 89S	01890	24 V DC
SLP 89Z	01891	230 V AC

## URINAL VILA WITHOUT COVER WITH THE RADAR FLUSHING UNIT



SLP 12R	01124	24 V DC
SLP 12RZ	01125	230 V AC
SLP 12RB	11127	6 V

## URINAL VILA WITH COVER (SYSTEM SOFT-CLOSE) AND WITH A RADAR FLUSHING UNIT



SLP 37R	01374	24 V DC
SLP 37RZ	01375	230 V AC
SLP 37RB	11377	6 V

## URINAL ARQ WITH COVER AND WITH THE RADAR FLUSHING UNIT



SLP 32R	01324	24 V DC
SLP 32RZ	01325	230 V AC
SLP 32RB	11327	6 V

## URINAL LIVO WITH THE RADAR FLUSHING UNIT



SLP 31RS	11315	24 V DC
SLP 31RZ	01315	230 V AC
SLP 31RB	11317	6 V

# RADAR FLUSHING UNITS



## RADAR FLUSHING UNIT FOR

- (GEBERIT) NOVA PRO FELIX 26 000;
- NOVA PRO ALEX 66 000;
- RENOVA NR. 11 235 300;
- NOVA PRO M36 000;
- RENOVA NR.1 PLAN 235 100 (KOLO);
- SELNOVA 500 344

SLP 07S	11071	24 V DC
SLP 07Z	01071	230 V AC
SLP 07B	11076	6 V



## RADAR FLUSHING UNIT FOR

- (OLYMPIA) OLYMPIA ORI50101

SLP 99S	ORI50101	24 V DC
SLP 99Z	ORI50101	230 V AC
SLP 99B	ORI50101	6 V



## RADAR FLUSHING UNIT FOR

- (VILLEROY & BOCH) SUBWAY 751300, 751301, 751305

SLP 71RS	11715	24 V DC
SLP 71RZ	11716	230 V AC
SLP 71RB	11717	6 V



## RADAR FLUSHING UNIT FOR

- (GSI) COMMUNITY 31x35 909811, 909826, 909817, 909809, 909711, 909726, 909717, 909709

SLP 99S	Community 31x35	24 V DC
SLP 99Z	Community 31x35	230 V AC
SLP 99B	Community 31x35	6 V



## RADAR FLUSHING UNIT FOR

- (LAUFEN) VAL 840281, 840285

SLP 99S VAL	VAL 840281	24 V DC
SLP 99B VAL	VAL 840281	6 V



## RADAR FLUSHING UNIT FOR

- (DURAVIT) VIU 281630, 281632

SLP 99S	VIU 281630, 281632	24 V DC
SLP 99Z	VIU 281630, 281632	230 V AC
SLP 99B	VIU 281630, 281632	6 V



## RADAR FLUSHING UNIT FOR

- (IDEAL STANDARD) SIMPLICITY E8772

SLP 99S	Simplicity E8772	24 V DC
SLP 99Z	Simplicity E8772	230 V AC
SLP 99B	Simplicity E8772	6 V



## RADAR FLUSHING UNIT FOR

- (HATRIA) FUSION YXE1 (YXC3)

SLP 99S	Fusion YXE1 (YXC3)	24 V DC
SLP 99Z	Fusion YXE1 (YXC3)	230 V AC
SLP 99B	Fusion YXE1 (YXC3)	6 V

# SANELA PRODUCTS APPLICATIONS

The use of the system **modernises** the building and increases its utility value.

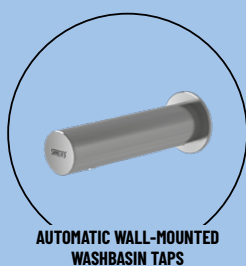

Examples of buildings where the **use of radar technology** is clearly beneficial.  
But it can also be used in other places, **there are no limits.**

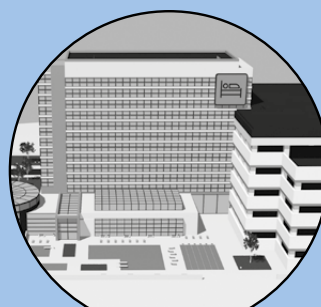
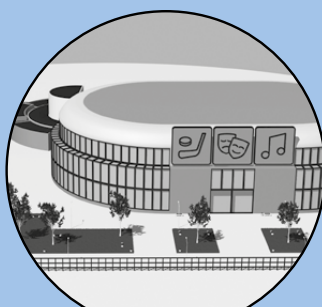
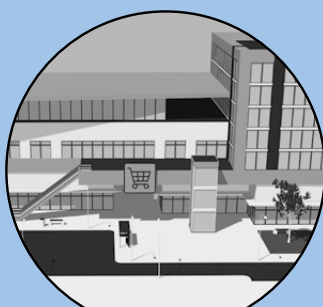



# SANELA CONTROL APP

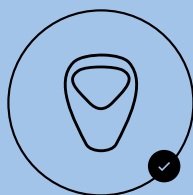

EASY  
ACCESS

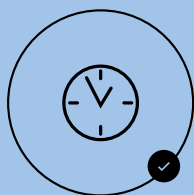

TIME  
SAVINGS



DEVICE  
PROTECTION

With this application, it is possible to quickly and efficiently set individual parameters for SANELA devices that contain a Bluetooth communication module. This application replaces the SLD remote controls. By starting the application, all SANELA devices with a Bluetooth module that are located nearby are automatically searched for.

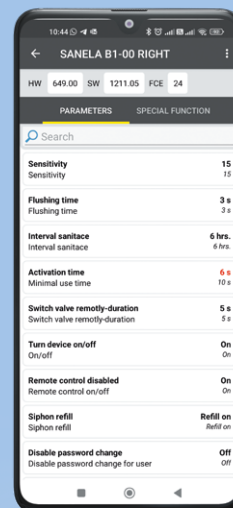
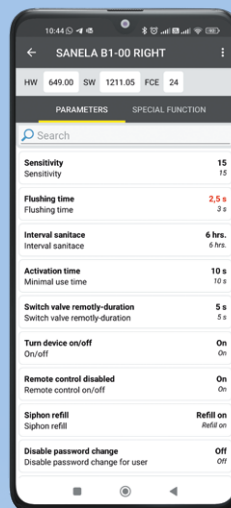

## FLUSH TIME

Can be set from 0.5 to 15.5 seconds. The customer can choose the optimal time himself, either for high water saving or for better hygiene.



## ACTIVATION TIME (MINIMUM USE TIME)

This is the minimum time the urinal must be used so that the Radar activates the flush. It is factory set at 10 seconds, but in specific installations such as kindergartens, elementary schools or elderly homes, this time can be reduced to a minimum of 6 seconds. This ensures correct flushing in all cases.

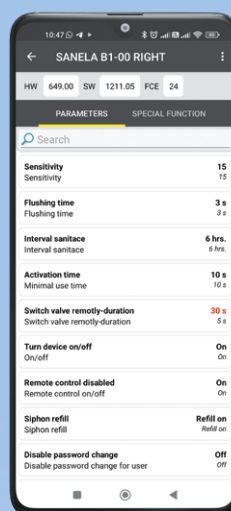

## NEXT FUNCTIONS:



### RENAME DEVICE

You can choose a custom name for each Radar to make it easier to identify for later parameter changes.



### ENTER A NEW PASSWORD

You can password-protect each Radar so that no one can access it.



## SWITCH VALVE ON REMOTELY (CLEANING MODE)

One press can activate flushing from 5-1200 seconds. Can be used when cleaning urinals, the cleaner can use enough water to perform a proper cleaning.



## SANITATION INTERVAL

You can choose after how long without using the urinal is automatically flushed.



## FACTORY SETTINGS

If you want to go back to the parameters set in our factory, it is possible with one press.

PAID APP AVAILABLE ON



**We manufacture our Radar technology** for many other types of ceramic urinals. Therefore, if you are interested, please do not hesitate to contact us to see if a radar flusher is available for your type of urinal.



**SANELA spol. s r.o.**

Dukelských hrdinů 989 • 563 01 Lanškroun, Czech Republic

tel.: +420 465 350 770-1

e-mail: [sanela@sanela.cz](mailto:sanela@sanela.cz)

[www.sanela.eu](http://www.sanela.eu)



EN ISO 9001:2015