

Stainless Steel Toilet SLWN 03



Characteristics



- **vandal-proof design**
- floor-standing WC for attachment to the wall and floor
- blind holes for the seat
- reinforced with polyurethane (reduced noise, increased strength)
- assembly using a mounting plate
- stainless steel material: AISI 304 (1.4301)
- brushed finish

Dimensions

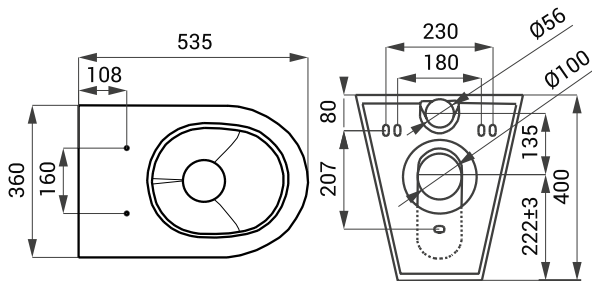

Technical Specification

Dimensions	535 x 360 x 400 mm
Weight	13 kg
Material thickness	1,5 / 3 mm

Supply Specification

SLWN 03 - Supply No. 94030 stainless steel WC

Recommended accessories

SLZN 31A - Supply No. 95315	WC seat black without lid, hardened plastic, stainless steel hinges
SLZN 31C - Supply No. 95313	WC seat black with lid, hardened plastic, stainless steel hinges
SLR 03 - Supply No. 08030	mounting frame for wall-hung WC and flush, which is located in the space above the WC (SLW 01NK, SLW 01P, SLW 01PA, SLW 03PA, SLP 05)
SLR 03A - Supply No. 08032	mounting frame for wall-hung WC and flush, which is located in the space above the WC (SLW 01NK, SLW 01P, SLW 01PA, SLW 03PA, SLP 05)
SLR 21 - Supply No. 08210	frame with tank designed for plasterboard constructions
SLR 21A - Supply No. 08212	mounting frame for wall-hung WC and flush buttons (mechanical, infrared and capacitive touch)