

# Stainless Steel Washbasin SLUN 58

## Technical sheet



SLUN 58

## Characteristics



- vandal-proof
- suitable for a prison
- stainless steel wall hung washbasin
- mounting over servis hole and special screws
- without a tap hole (could be made to order)
- material AISI - 304
- brushed

## Dimensions

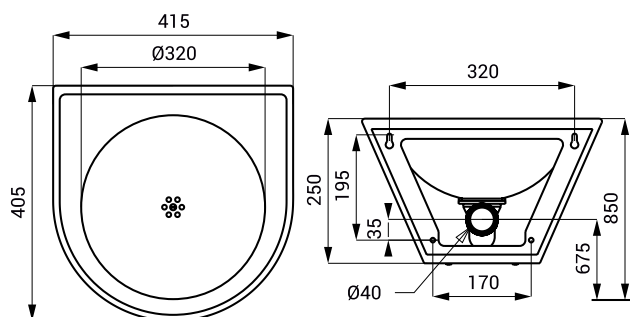

## Technical Specification

Dimensions	415 x 250 x 405 mm
Weight	4,2 kg
Thickness of material	1,2/1 mm

## Supply Specification

SLUN 58 - Supply No. 93580    stainless steel washbasin, siphon, mounting set