

RFID door lock system SLZA 30A, SLZA 30AZ



SLZA 30AZ



SLZA 30A

Characteristics

- stainless steel RFID door lock system (12 V)
- for door opening with token
- model with index A - on the wall
- model with index AZ - recessed
- material AISI - 304
- brushed finish

Dimensions

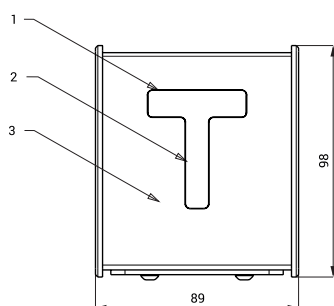

SLZA 30A

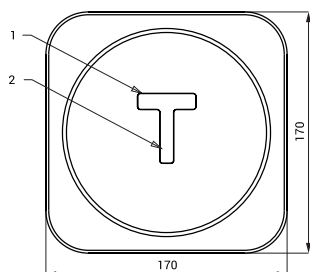
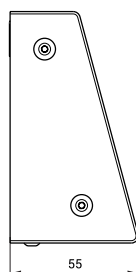

SLZA 30AZ

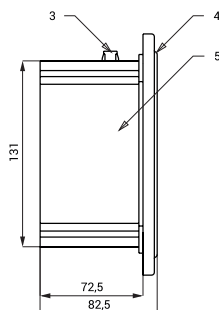

Technical Specification

**Stainless steel cover dimensions
(SLZA 30AZ)**

170 x 170 x 10 mm

**Plastic mounting box dimensions
(SLZA 30AZ)**

140 x 140 x 75 mm

Dimensions (SLZA 30A)

96 x 74 x 51 mm

Operating voltage

24 V DC

Power input

12 W

- 1 - display
2 - RFID active range
3 - stainless steel case with plastic sideboards

- 1 - display
2 - RFID active range
3 - power supply 24 V DC
4 - stainless steel cover with electronics
5 - plastic mounting box

Supply Specification

SLZA 30A - Supply No. 89303

stainless steel station with display

SLZA 30AZ - Supply No. 89304

stainless steel cover with display, plastic mounting box

Recommended Accessories

SLZ 01Y - Supply No. 05012
SLZ 01Z - Supply No. 05011
SLZ 04Y - Supply No. 05042
SLZ 04Z - Supply No. 05041
SLZ 04X - Supply No. 10049
SLZA 30 - Supply No. 89300
SLZA 38 - Supply No. 89380
SLZA 51 - Supply No. 88510
SLZA 51B - Supply No. 88511
SLZA 51R - Supply No. 88512

power supply 24 V DC for operating of max. 5 pcs. door lock systems
power supply 24 V DC for operating of max. 9 pcs. door lock systems
power supply 24 V DC for DIN rail, for operating of max. 5 pcs. door lock systems
power supply 24 V DC for DIN rail, for operating of max. 9 pcs. door lock systems
power supply 24 V DC for DIN rail, for operating of max. 15 pcs. door lock systems
programming station for RFID tokens
programming station for RFID tokens
set of 50 pcs. of plastic RFID tokens for token machines, yellow color
set of 50 pcs. of plastic RFID tokens for token machines, blue color
set of 50 pcs. of plastic RFID tokens for token machines, red color
(logo on the token is not possible)
protective cover above the recessed machines
protective cover above the wall-mounted machines